

Centre drills 60°

form A



SC

CZ Středící vrtáky SK 60° | tvar A

DE Zentrierbohrer 60° | Form A

RU Центровочные сверла 60° | Форма А

VS92012

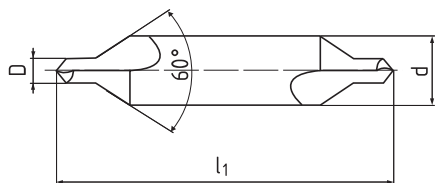

new



| D | d | l2 | l1 | VS92012 | | | | |
|------|------|-----------|----|---------|--|--|--|--|
| 1,0 | 3,15 | 1,3 - 1,7 | 31 | .010 | | | | |
| 1,25 | 3,15 | 1,6 - 2,0 | 31 | .0125 | | | | |
| 1,6 | 4,0 | 2,0 - 2,6 | 35 | .016 | | | | |
| 2,0 | 5,0 | 2,5 - 3,1 | 40 | .020 | | | | |
| 2,5 | 6,3 | 3,1 - 3,8 | 45 | .025 | | | | |
| 3,15 | 8,0 | 3,9 - 4,6 | 50 | .0315 | | | | |
| 4,0 | 10,0 | 5,0 - 5,9 | 55 | .040 | | | | |

HSS/SC

VS92012

- P.1
- P.2
- P.3
- M.1
- M.2
- M.3
- N.1
- N.4