

# Centre drills 60°

form A |

DIN  
333A

**CZ** Středící vrtáky 60° | tvar A

**DE** Zentrierbohrer 60° | Form A

**RU** Центроворные сверла 60° | форма А

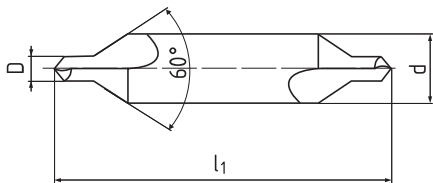

## VS92010

## VS92015

new



VS92010

HSS

new



VS92015

HSS  
Co5

D	d	l1	l2	VS92010		VS92015	
1,0	3,15	31	1,3 - 1,7	.010		.010	
1,25	3,15	31	1,6 - 2,0	.0125		.0125	
1,6	4,0	35	2,0 - 2,6	.016		.016	
2,0	5,0	40	2,5 - 3,1	.020		.020	
2,5	6,3	45	3,1 - 3,8	.025		.025	
3,15	8,0	50	3,9 - 4,6	.0315		.0315	
4,0	10,0	55	5,0 - 5,9	.040		.040	
5,0	12,5	63	6,3 - 7,2	.050		.050	
6,3	16,0	71	8,0 - 8,9	.063			
8,0	20,0	80	10,1 - 11,1	.080			
10,0	25,0	100	12,8 - 13,8	.100			

HSS/SC

VS92010 **P.1** **P.2** **N.1** **N.4**

VS92015 **P.1** **P.2** **P.3** **K.1** **N.1** **N.4**