

2

Tipo (grandezza) morsa / Vise (type) size	kN	1		2		3		4	
		16 kN	25 kN	30 kN	30 kN	30 kN	30 kN	30 kN	
Apertura massima / Maximum spread	A1	2 x 90	2 x 100	2 x 110	2 x 160	2 x 120	2 x 170	2 x 220	2 x 270
	W	96	121	146				171	
	B	28	38	48				58	
	C	35	40	50				58	
	D	460	520	580	680	666	766	866	966
	G	75	95	125				145	
	kg	6.8	12.9	25.5	29	37	42	47	52
	Cod.	2.30.A190	2.30.A2100	2.30.A3110	2.30.A3160	2.30.A4120	2.30.A4170	2.30.A4220	2.30.A4270

Art. 30A

Morsa *XL a doppia apertura con ganasce a cambio rapido (sistema a pettine)

* Serraggi disassati lateralmente non possibili

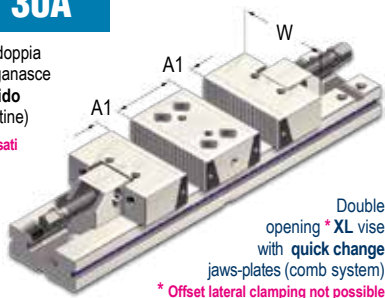

Double opening *XL vise with quick change jaws-plates (comb system)

* Offset lateral clamping not possible

AMPLIA LE TUE APPLICAZIONI TRAMITE GLI ACCESSORI MODULARI !
Art. 230E

Piastra ganascia intercambiabile Interchangeable jaw plate

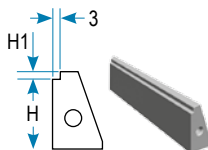

	Cod.	4.23.0E101	4.23.0E201	4.23.0E301	4.23.0E401
H	23	33	43	53	
H1	5	5	5	5	

Art. 212

Ganascia mobile intermedia (da usare con Art. 230E)

Intermediate movable jaw (to be used with Art. 230E)

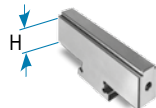

	Cod.	1.21.21000	1.21.22000	1.21.23000	1.21.24000

Art. 230B

Piastra ganascia intercambiabile dolce Soft interchangeable jaw plate

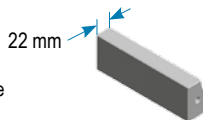

	Cod.	4.23.0B101	4.23.0B201	4.23.0B301	4.23.0B401

Art. 230F

Piastra ganascia intercambiabile prismatica Prismatic interchangeable jaw plate

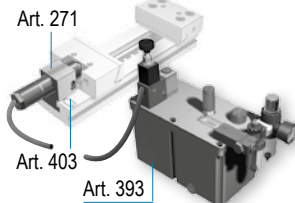

	Cod.	4.23.0F101	4.23.0F201	4.23.0F301	4.23.0F401

Art. 391
 CNC / CNC

Art. 392
 Pneumatico / Air control

	Cod.	4.39.11000	4.39.12000	4.39.13000	4.39.14000
	Cod.	4.39.21000	4.39.22000	4.39.23000	4.39.24000

 Servocomandi oleopneumatici (completi di 1 cilindro e supporto) per serraggi multipli **contemporanei** o **indipendenti**, da 2 a 6 morse. Vedi da pag. 4.36 a 4.47

Dotazione standard:

- 2 arresti laterali Art. 370
- 1 coppia di tasselli di posizionamento Art. 297 (Standard per cava da 16 mm; altre dimensioni a richiesta senza variazione di prezzo)
- 2 tappi Art. 291 ■ 1 chiave a pipa Art. 375 ■ 1 chiave a "T" Art. 376

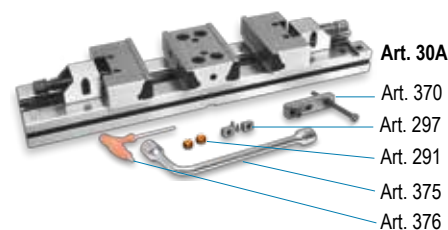
Standard equipment:

- 2 workstops Art. 370
- 1 pair of positioning key-nuts Art. 297 (Standard for 16 mm slot. Other dimensions available on request without price change)
- 2 inserts Art. 291 ■ 1 box wrench Art. 375 ■ 1 T-wrench Art. 376

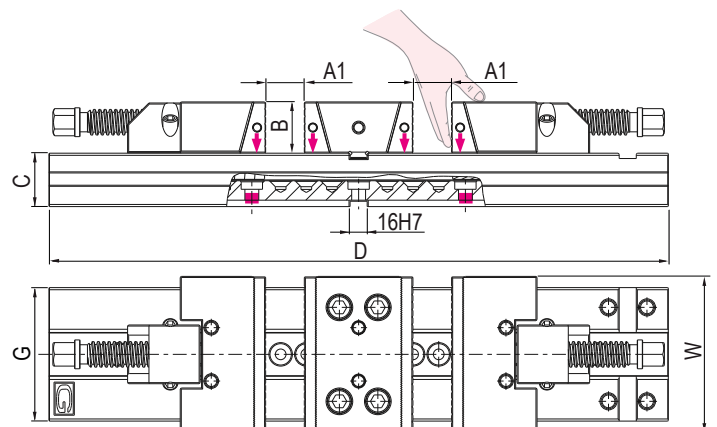
 Vedi gruppo 4 per gamma completa accessori
 See group 4 for complete range of accessories